

Sacramento, CA

# DOS RIOS BUSINESS COMPLEX

1106 NORTH D STREET  
FOR LEASE



**For Further Information,  
Please Contact:**

**Brian English**  
benglish@centurymgmt.com

**Keith Galliano**  
kgalliano@centurymgmt.com

**1001 Enterprise Way, Suite 250  
Roseville, CA 95678  
Phone: (916) 784-3666  
Fax: (916) 784-3667**

Unit #22

3,984 Square Feet

## Features:

- 285 square foot office
- 1 grade-level door
- Zoned M-1
- Gross, no C.A.M. fee lease
- Minutes to Downtown Sacramento

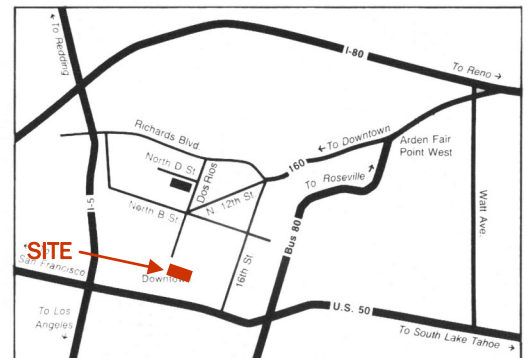

**Century  
Management  
Company**

Sacramento, CA

# DOS RIOS BUSINESS COMPLEX

— 48' —

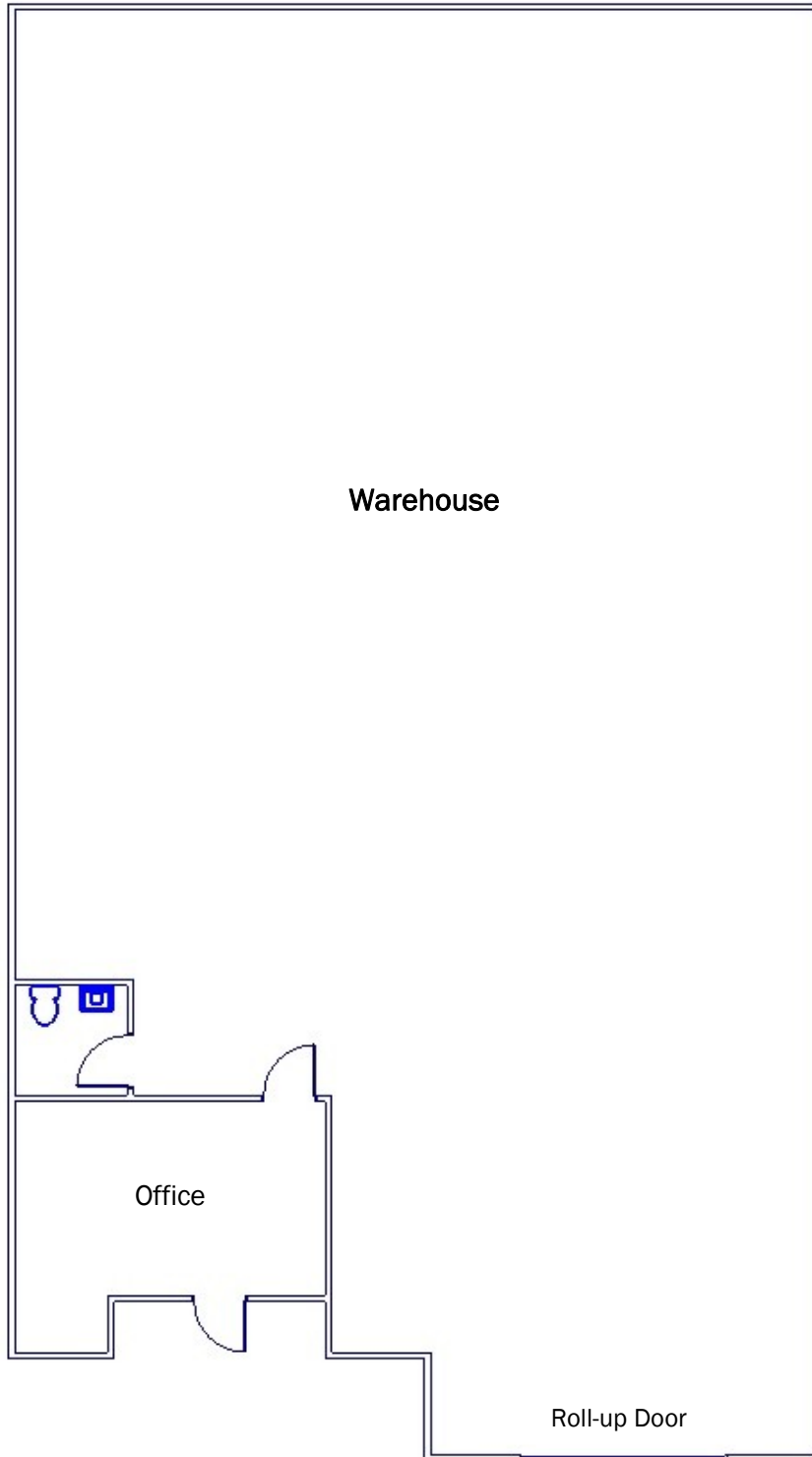

86'

(Not to scale)